



D & D PRODUCTION INC.

ASSEMBLY NO. 243212A-2M

HEAD NO. 2472

CROWFOOT ASS'Y
Rev. A
01-10-97

2500 WILLIAMS DRIVE • WATERFORD, MI • 48328

PHONE : (248) 334-2112 • FAX : (248) 334-0062

SIDE VIEW

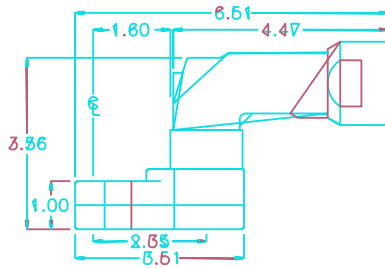

TOP VIEW

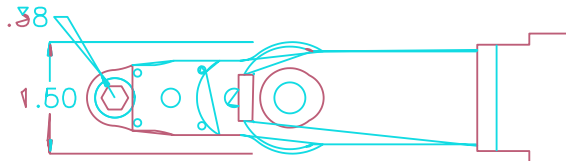

GEAR ASSEMBLY

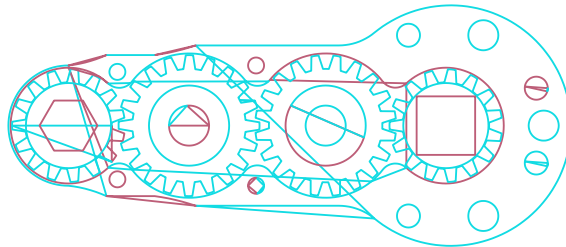

PARTS BLOWOUT

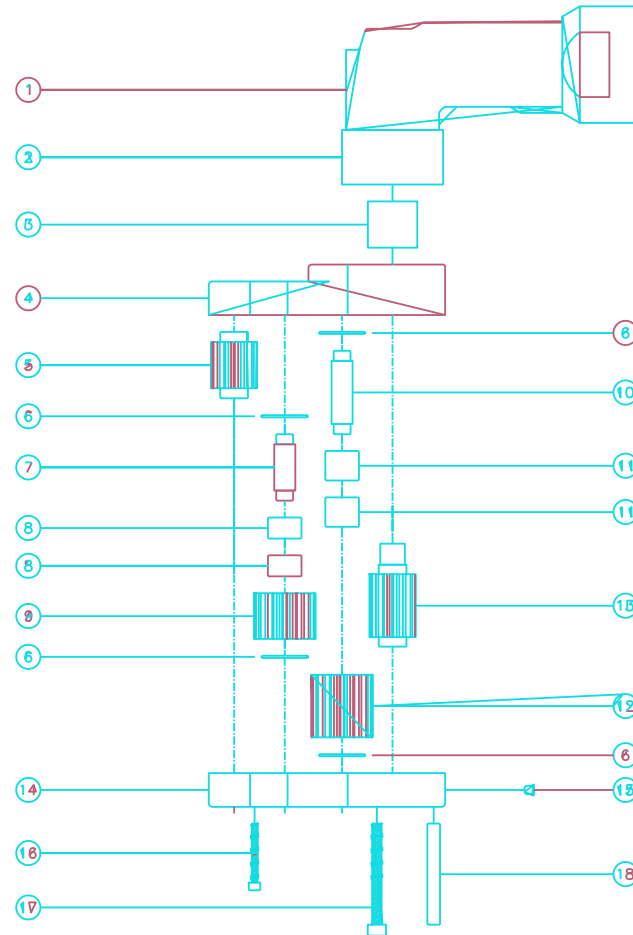

ITEM	DESCRIPTION	PART NO.	ITEM	DESCRIPTION	PART NO.	ITEM	DESCRIPTION	PART NO.
1	Angle Head	GSE 5714	11	Needle Bearing #2 (2)	B-57			
2	Housing Adapter	HA5714-322026	12	Idler Gear #2	242030			
3	Drive Shaft	DS-38S2422	13	Drive Gear	241540-MSD			
4	Gear Housing (Top)	243212A-2M-H	14	Gear Housing (Bottom)	243212A-2M-P			
5	Socket Gear	241532-XX	15	Grease Fitting	1877			
6	Thrust Race (4)	TRA-411	16	Screw #1 (4)	S-414SH			
7	Idler Pin #1	IP-5532	17	Screw #2 (4)	S-824SH			
8	Needle Bearing #1 (2)	B-55	18	Dowel Pin (3)	DP-1224			
9	Idler Gear #1	242022						
10	Idler Pin #2	IP-5740						